

Double Face Applications (Universal Models Only)

1. Remove safety tabs to free back plate retainer clips.
2. Disengage detents on bottom edge of back plate and press both retainer clips inward to remove back plate.
3. Place double face stencil assembly onto back side of exit frame and snap into place.

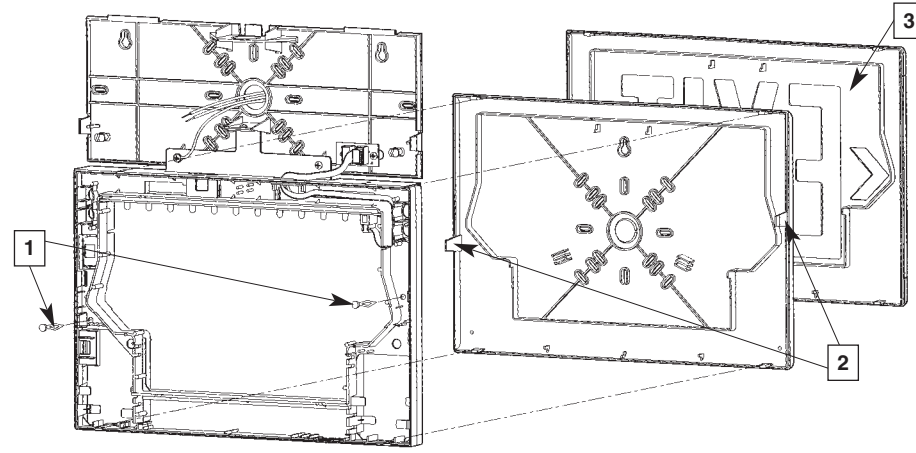

Final Assembly

1. Dress wires neatly to prevent pinching.
2. Align housing slots over back plate tabs.
3. Pivot housing and snap closed.
4. Energize unit. Charge a minimum of 24 hours prior to testing.
5. Press test switch and hold. Aim lamp heads for proper light distribution.

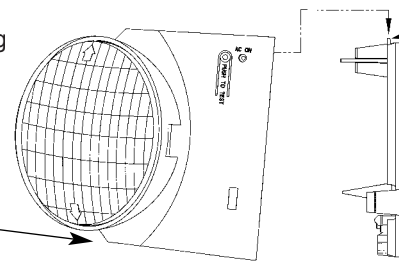

TROUBLE SHOOTING

AC-On Light does not illuminate

- Check AC wiring connections.

Exit Sign does not illuminate

- Check AC wiring and ribbon cable connections.

Emergency lamps do not work

- Battery is shipped disconnected. Connect red lead from PC board to positive (+) battery terminal and charge before testing.
- Make sure charger board is properly seated.
- Check wiring connections.

MAINTENANCE

Units should be tested and maintained in accordance with National Electrical Code and NFPA 101 Life Safety Code requirements. It is recommended that emergency lighting units be tested for 30 seconds once a month and for 90 minutes once a year.

RECYCLING INFORMATION

All thermoplastic parts are recyclable. All cartons contain recycled materials. Please recycle.



NOTICE:

Units contain rechargeable lead-acid or nickel-cadmium batteries which must be recycled or disposed of properly.

LAMP REPLACEMENT

CAUTION: Allow defective lamp to cool completely before attempting replacement.

1. Remove plastic lamp lens by prying carefully with screwdriver at arrow locations.
2. Pull defective lamp from lighting head assembly and unplug lamp from socket.
3. Plug replacement lamp into socket and install lamp into lighting head assembly.
4. Re-install lamp lens.

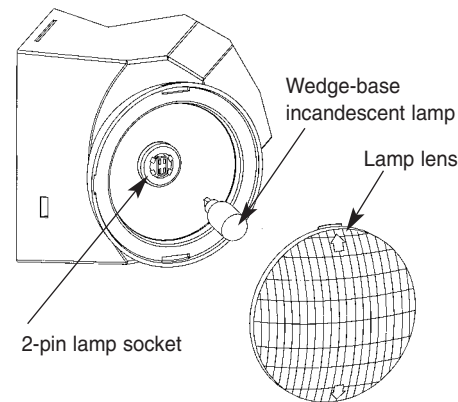

DUAL LITE

CVT3 Series Combination Emergency Unit/ LED Exit Signs

Installation Instructions



IMPORTANT SAFEGUARDS

When using electrical equipment, basic safety precautions should always be followed including the following:

READ AND FOLLOW ALL SAFETY INSTRUCTIONS

1. Do not use outdoors.
2. Do not mount near heaters or hot surfaces.
3. Equipment should be mounted in locations and at heights where it will not readily be subjected to tampering by unauthorized personnel.
4. The use of accessory equipment not authorized by the manufacturer may cause an unsafe condition.
5. Do not use this equipment for other than its intended purpose.
6. Service of this equipment should be performed by qualified service personnel.

Emergency Lighting And Power Equipment For Use In Damp Locations

Damp location listed units are suitable for installation in:

1. Interior locations subject to moderate degrees of moisture, such as some basements, some barns, some cold-storage warehouses, and the like.
2. Partially protected locations under canopies, marquees, roofed open porches and the like.



SAVE THESE INSTRUCTIONS

Hubbell Lighting, Inc.

COMBO UNIT INSTALLATION INSTRUCTIONS

Battery Installation and Connections

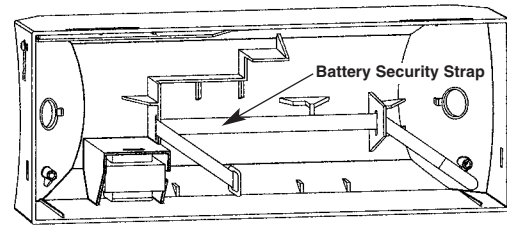

On models shipped with battery uninstalled, check that battery security strap is positioned as shown above.

Lead-Calcium Battery Models

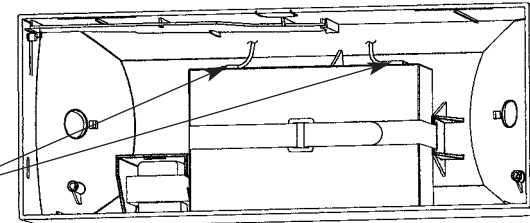

Battery Connections:
Connect yellow circuit board lead to battery negative (-) terminal.
Note: On factory installed batteries, yellow battery lead is shipped connected.
Connect red circuit board lead to battery positive (+) terminal.

- 1) Place battery in housing as shown above in front of security strap.
- 2) Fasten by tightening security strap.

Nickel-Cadmium Battery Models

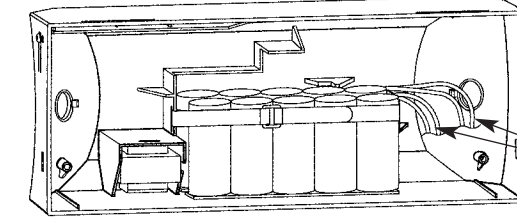

Battery Connections:
Connect battery harness leads from circuit board to corresponding leads from battery assembly.

- 1) Remove double-sided tape protective layer on bottom of battery assembly.
- 2) Position battery in housing in front of security strap as shown above and press battery firmly in place.
- 3) Fasten by tightening security strap.

Wall Mount (Back Power Feed)

1. Remove center 3/4" K.O. in unit back plate.
2. Remove appropriate back plate K.O.s for electrical box screws.
3. Feed wires through center K.O. and mount back plate to electrical box.

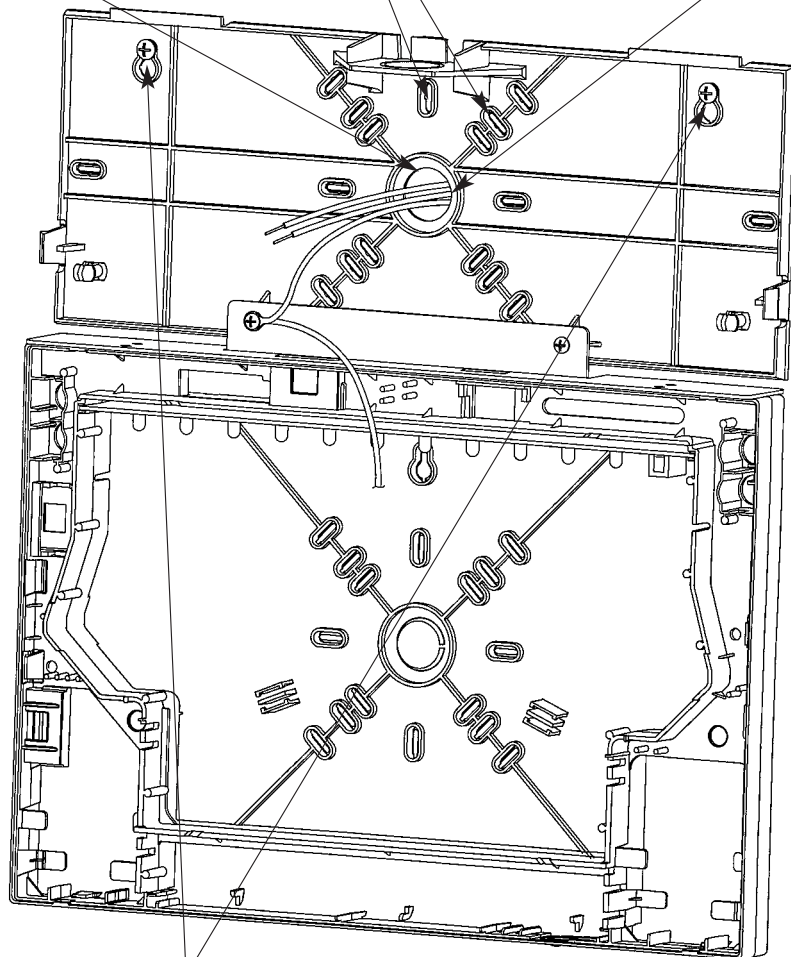

4. Using appropriate hardware, mechanically secure unit backplate to wall surface through keyhole K.O.s

Ceiling (Top) Mount

1. Feed building wires through threaded nipple in ceiling mount base plate and affix the plate to electrical box using screws provided with box.
2. Attach unit mounting bracket to screw studs in base plate using two screws provided.
3. Remove 4 appropriate K.O.s in unit back plate mounting pattern and 3/4" K.O. in unit back plate top flange.

Grounding pigtail leads (Refer to "IMPORTANT" note below)

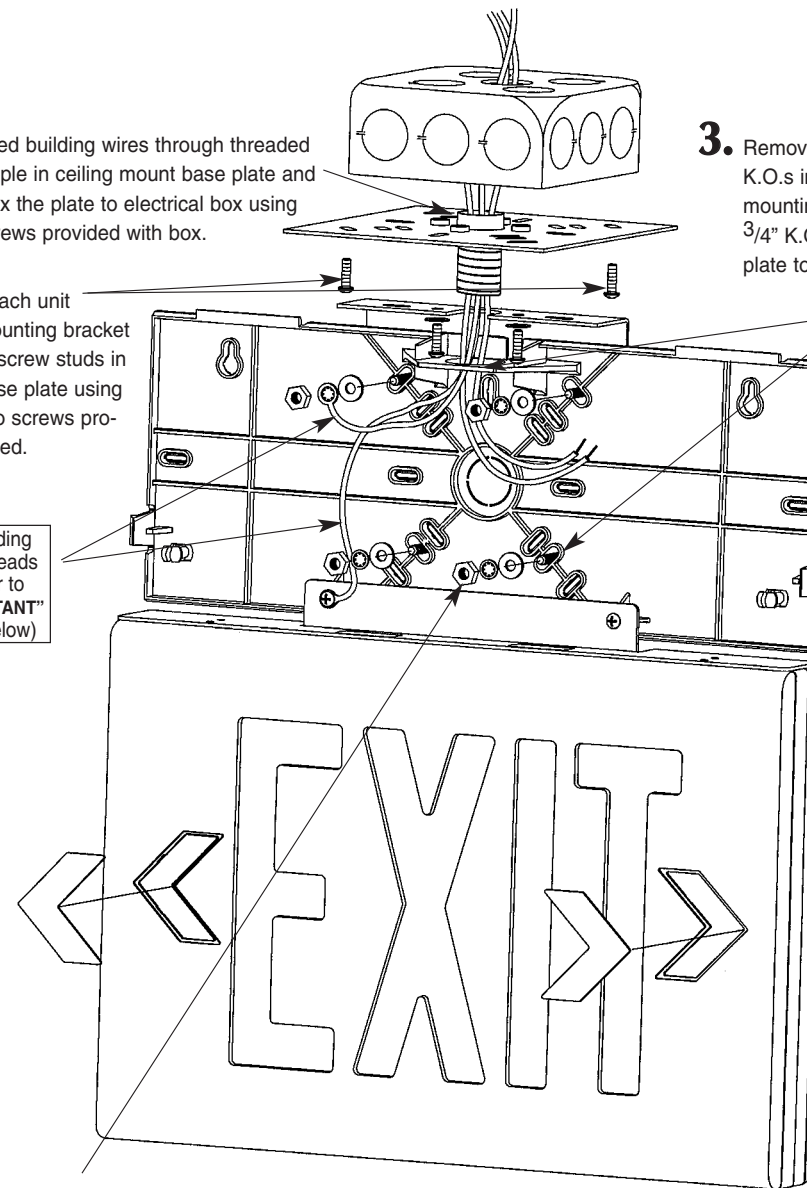

4. Place unit back plate onto screw studs in bracket assembly and secure with #8 locking hardware provided. Make sure threaded nipple (used as wiring channel) extends from base plate through the 3/4" hole in unit back plate top flange.

IMPORTANT: Two grounding pigtail leads are provided. In ceiling mounted applications, both grounding pigtails must be properly connected to building utility ground for safety reasons.

Electrical Connections (All Models)

1. Attach unit housing to back plate by plastic hinge straps provided.
2. Connect building wires to transformer leads.
 - Black and white wires for 120V (Use wire nut to cap off red wire)
 - Red and white wires for 277V (Use wire nut to cap off black wire)
 - Brown and blue wires for 220/240V
 - Make proper connection to ground
3. Connect remote lighting load to yellow and blue (fused) pigtail leads provided (remote capacity models only).
4. Route ribbon cable through housing as shown and plug connector into LED printed circuit board assembly.
5. Fire Alarm Panel Option (-FAP)
Connect two violet pigtail leads from flasher module on PC board to appropriate 24 volt AC or DC fire alarm panel. Wiring connections may be made inside unit housing or within electrical box.

To complete installation, see Final Assembly instructions on back page.